

QTY	PART NUMBER	DESCRIPTION
1	382-ADJ-A-*	OUTER TUBE +
1	382-ADJ-G	JAM NUT +
1	382-ADJ-F	ADJUSTABLE EXTENSION BASE +
1	382-B-*-§	INNER FLUID TUBE AND TIP <
1	382-C-*-§	NEEDLE <
1	302	TIP GASKET

< = SOLD AS SET ONLY (TSM-382-D-*-§)

+ = INCLUDED IN TSM-382-ADJ-A-*-~ ASSEMBLY

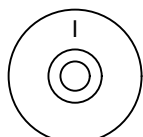
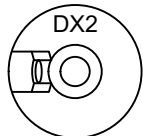
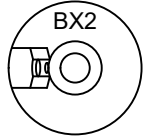

STANDARD AIR CAPS +

BX2
DX2
NAP
382-I

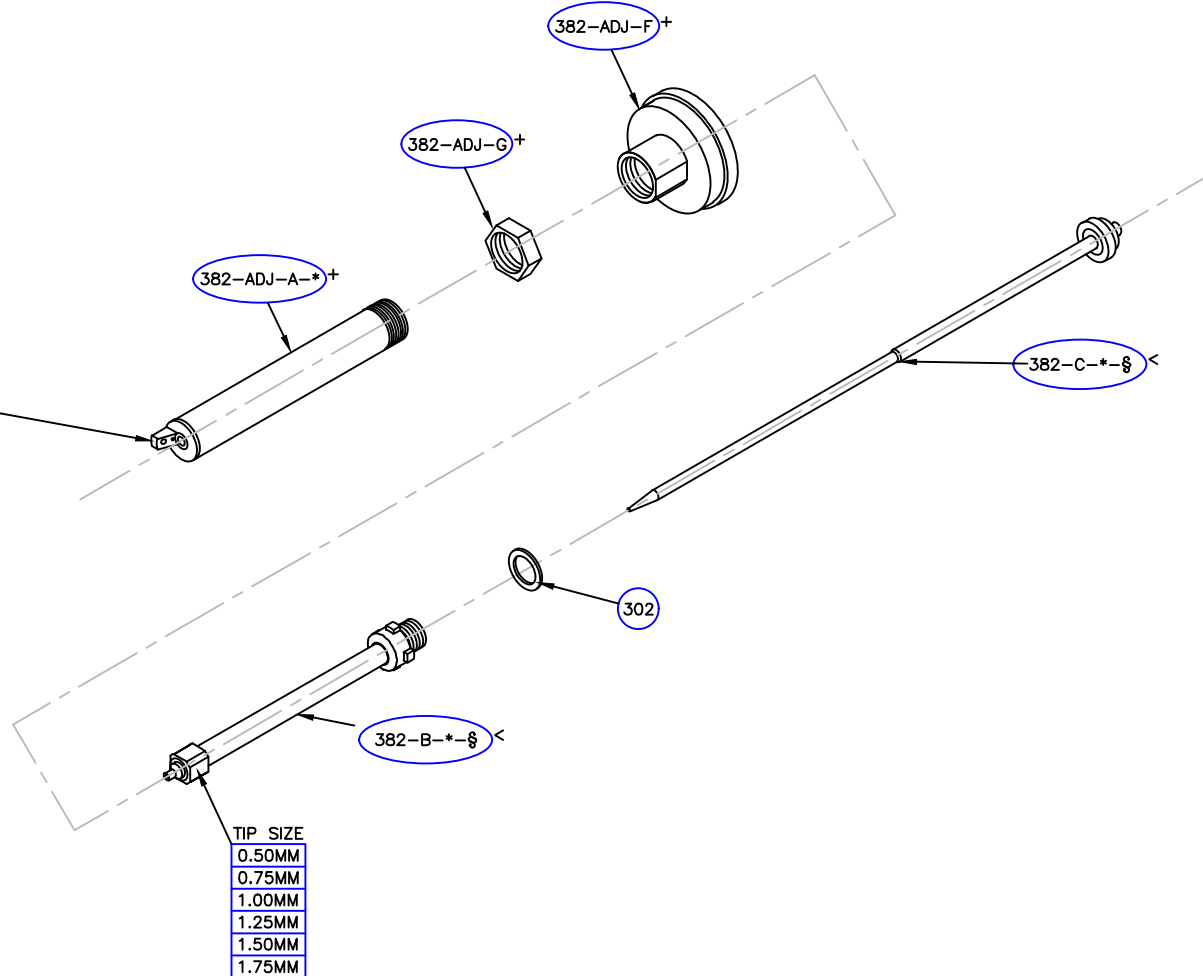

EXTENSION MODEL CONFIGURATION

TSM-382-ADJ-

LENGTH	
6	
8	

TIP AND NEEDLE SIZE	
0.50	
0.75	
1.00	
1.25	
1.50	
1.75	

AIR CAP	
BX2	
DX2	
NAP	
I	

1172 FENDT DRIVE
HOWELL, MI 48843
PHONE (517) 548-9096
FAX (517) 548-9328

**TURBO
SPRAY**

LEADERS IN LOW PRESSURE SINCE 1980!

TITLE		
382 ADJUSTABLE 1/2" DIAMETER EXTENSION KIT		
DATE	SHEET	PART NO.
02/07/19	1 OF 1	382-ADJ
SCALE	DRAWN BY	DRAWING NO.
NONE	JF	382ADJEXTLAWN.DWG

= CONTACT FOR ADDITIONAL OPTIONS AVAILABLE