

QTY	PART NUMBER	DESCRIPTION
1	321	AIR CAP LOCKING RING
1	302	TIP GASKET
1	322	DISTRIBUTOR
1	308	FLUID TUBE
1	303	PACKING
1	834A-C	COLLECTOR BODY
1	306-FM	FLUID TUBE INSERT
1	306	FLUID FITTING
1	317	FLUID TUBE NUT
1	324	FAN CONTROL KNOB
1	326	FAN CONTROL SPRING
1	325	FAN CONTROL SCREW
1	841M	HANDLE
1	807	TRIGGER
1	808	TRIGGER AXLE
1	811	NEEDLE SPRING
1	812	NEEDLE STOP ASSEMBLY
1	813	NEEDLE STOP SPRING
1	814	LEATHER STRAP
1	887	CHECK VALVE ASSEMBLY
2	888	BARB FITTING
1	881	1 QT. PRESSURE CAP

+/@ = INCLUDED IN REBUILD KIT TSM-850-G-1***
 < = SOLD AS TSM-327 SET ONLY ***
 +/% = INCLUDED IN REBUILD KIT TSM-850-G***

WINGED STYLE ***
TIP OPTIONS

SET NO.	SIZE
124	1.00MM
125	1.25MM
126	1.50MM
127	1.75MM
133	2.00MM
137	2.50MM

STANDARD AIR CAPS #

215
216
218
230
320

HEX STYLE ***
TIP OPTIONS

SET NO.	SIZE
290	0.50MM
289	0.75MM
291	1.00MM
292	1.25MM
293	1.50MM

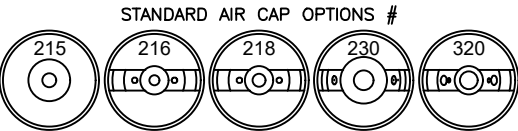

STANDARD AIR FITTINGS #

3175-60-14	3/8
3175-62-14	1/2

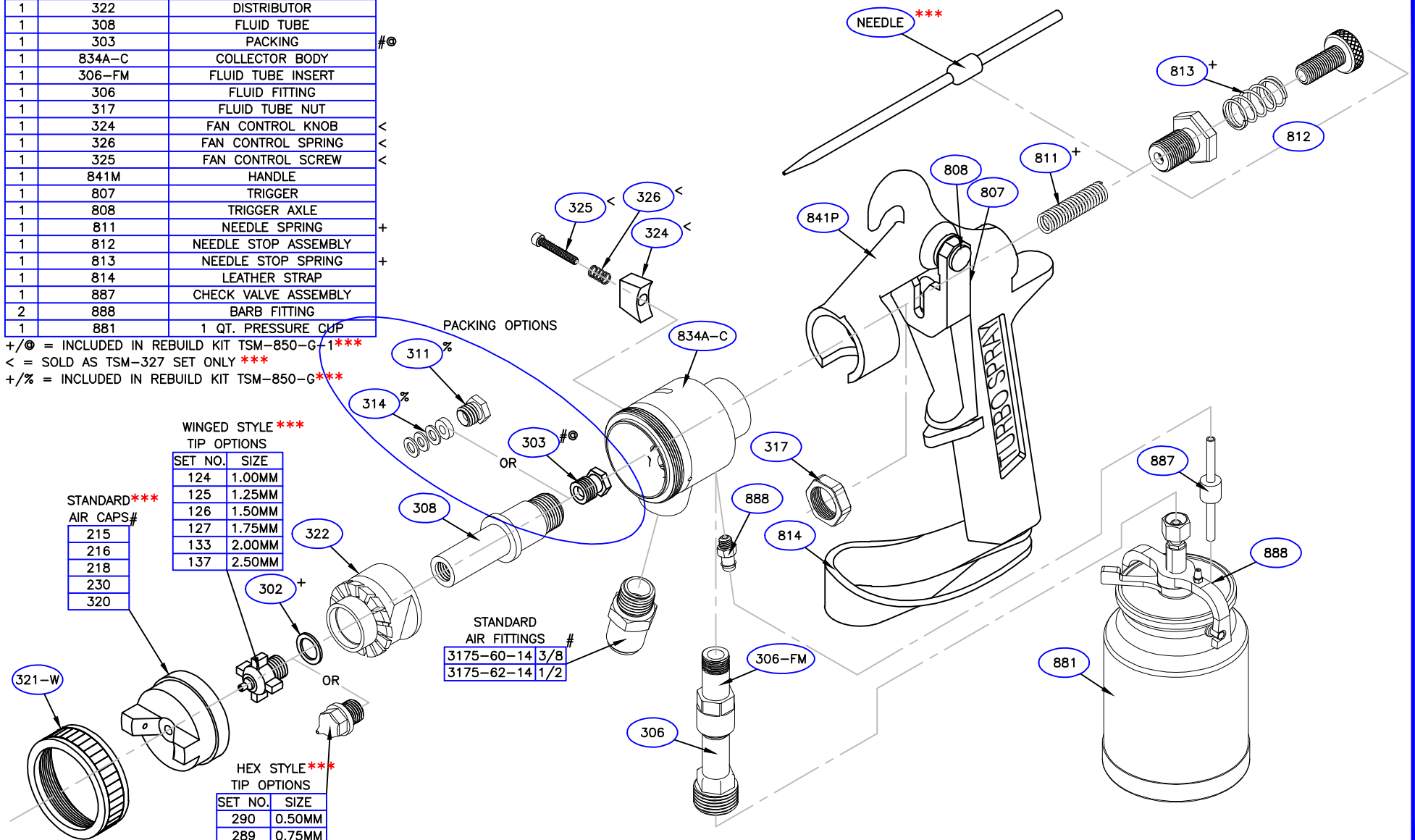

MODEL #: 880

ORDERS/PRICING:
 (517) 548-9096
 ORDERS@TURBOSPRAY.COM

1172 FENDT DRIVE
 HOWELL, MI 48843
 PHONE (517) 548-9096
 FAX (517) 548-9328

**TURBO
 SPRAY**

LEADERS IN LOW PRESSURE SINCE 1980!

*** = RECOMMENDED SPARE PARTS TO PREVENT DOWN TIME
 # = CONTACT FOR ADDITIONAL OPTIONS AVAILABLE