

# NEW IN 2023!

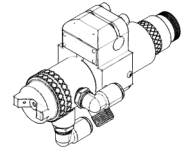

We have redesigned our (TSM-308) Fluid Tube and (TSM-306) Fluid Tube Inserts. The new design started shipping on new gun builds as of November 1st. This newly designed (TSM-368) Fluid Tube, (TSM-367) Crush Washer and (TSM-366 or TSM-366-FM) Fluid Inserts function the same as the old parts and will not effect your current setup, so you may have not even noticed. The new and old parts however are not interchangeable with each other and would need to be replaced as a set.

Please feel free to contact us at [engineer@turbospray.com](mailto:engineer@turbospray.com) if you have an questions!

