

QTY	PART NUMBER	DESCRIPTION
1	321-W	AIR CAP LOCKING RING
1	302	TIP GASKET
1	322-A	ANALOG DISTRIBUTOR
1	368-R	RECIRC FLUID TUBE
1	303	PACKING
1	301M-AR	GUN BODY
2	367	CRUSH WASHER
2	366	FLUID TUBE INSERT
1	318	FLUID TUBE WASHER
1	317	FLUID TUBE NUT
1	309	TRIGGER FITTING
1	315	LEATHER PACKING
1	310	PACKING SCREW
1	319	PISTON
1	305	O-RING
1	312-G	NEEDLE SPRING
1	313	PISTON SPRING
1	329	RATCHET
1	307	NYLON GUN BRACKET
2	336	GUN MOUNTING SCREWS
4	337	BRACKET MOUNTING SCREWS

+/@ = INCLUDED IN REBUILD KIT TSM-350-G-1***
 +/% = INCLUDED IN REBUILD KIT TSM-350-G***

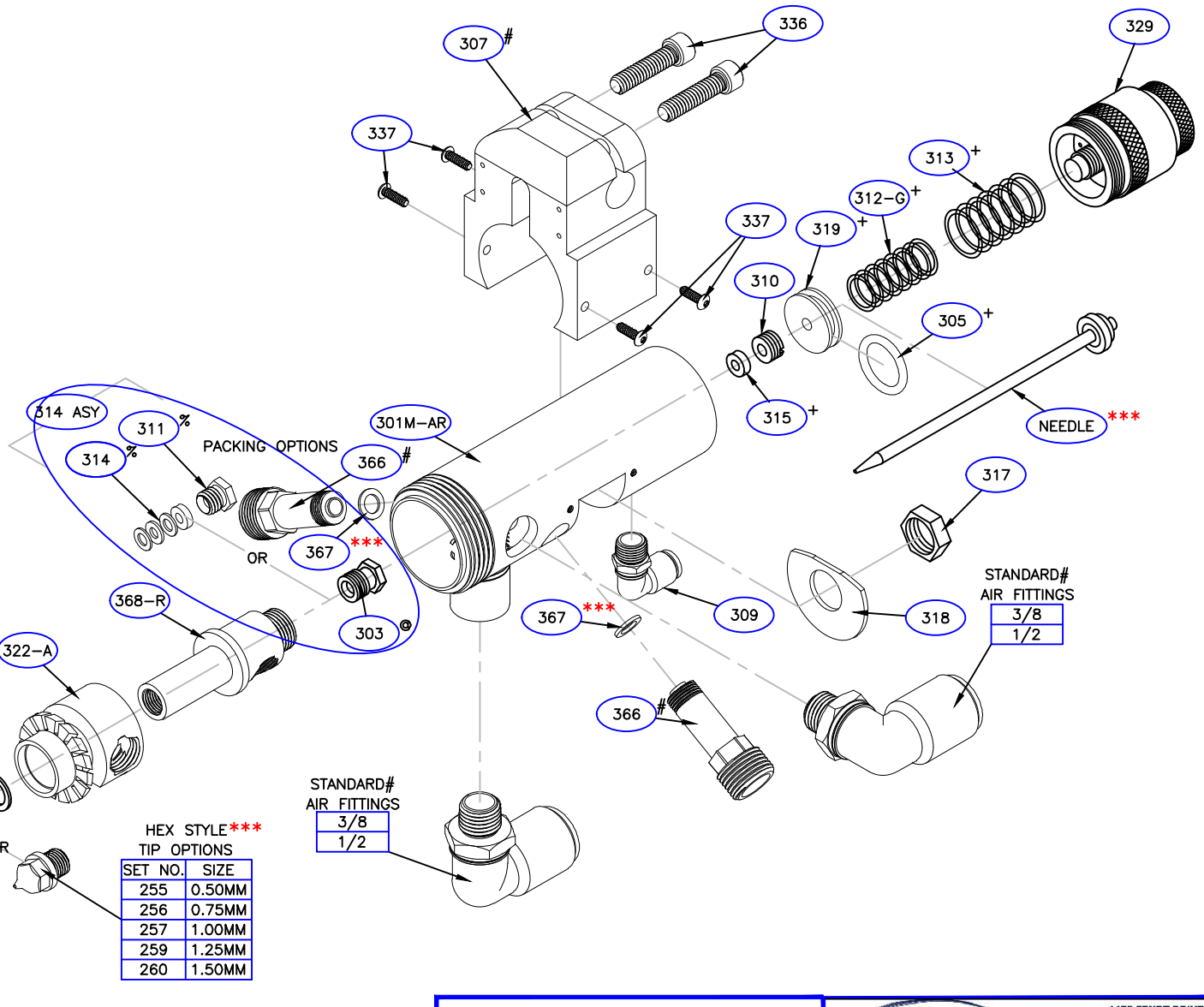

STANDARD***
AIR CAPS#

215
216
218
230
320

WINGED STYLE ***
TIP OPTIONS

SET NO.	SIZE
120	1.00MM
121	1.25MM
122	1.50MM
129	1.75MM
131	2.00MM
139	2.50MM

HEX STYLE ***
TIP OPTIONS

SET NO.	SIZE
255	0.50MM
256	0.75MM
257	1.00MM
259	1.25MM
260	1.50MM

STANDARD#
AIR FITTINGS

3/8
1/2

STANDARD#
AIR FITTINGS

3/8
1/2

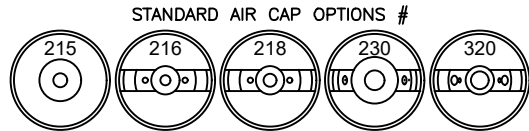

*** = RECOMMENDED SPARE PARTS TO PREVENT DOWN TIME
 # = CONTACT FOR ADDITIONAL OPTIONS AVAILABLE

MODEL #:
300M-AR

ORDERS/PRICING:
(517) 548-9096
ORDERS@TURBOSPRAY.COM

1172 FENDT DRIVE
HOWELL, MI 48843
PHONE (517) 548-9096
FAX (517) 548-9328

**TURBO
SPRAY**

LEADERS IN LOW PRESSURE SINCE 1980!

QTY	PART NUMBER	DESCRIPTION
1	321-W	AIR CAP LOCKING RING
1	302	TIP GASKET
1	322-A	ANALOG DISTRIBUTOR
1	368-R	RECIRC FLUID TUBE
1	303	PACKING
1	301M-AR	GUN BODY
2	367	CRUSH WASHER
2	366	FLUID TUBE INSERT
1	318	FLUID TUBE WASHER
1	317	FLUID TUBE NUT
1	309	TRIGGER FITTING
1	315	LEATHER PACKING
1	310	PACKING SCREW
1	319	PISTON
1	305	O-RING
1	312-G	NEEDLE SPRING
1	313	PISTON SPRING
1	329	RATCHET
1	307-ALU	ALUMINUM GUN BRACKET
2	336	GUN MOUNTING SCREWS
1	339-ALU	BRACKET BELLY COVER
6	337-ALU	BRACKET MOUNTING SCREWS

+/@ = INCLUDED IN REBUILD KIT TSM-350-G-1***
 +/% = INCLUDED IN REBUILD KIT TSM-350-C***

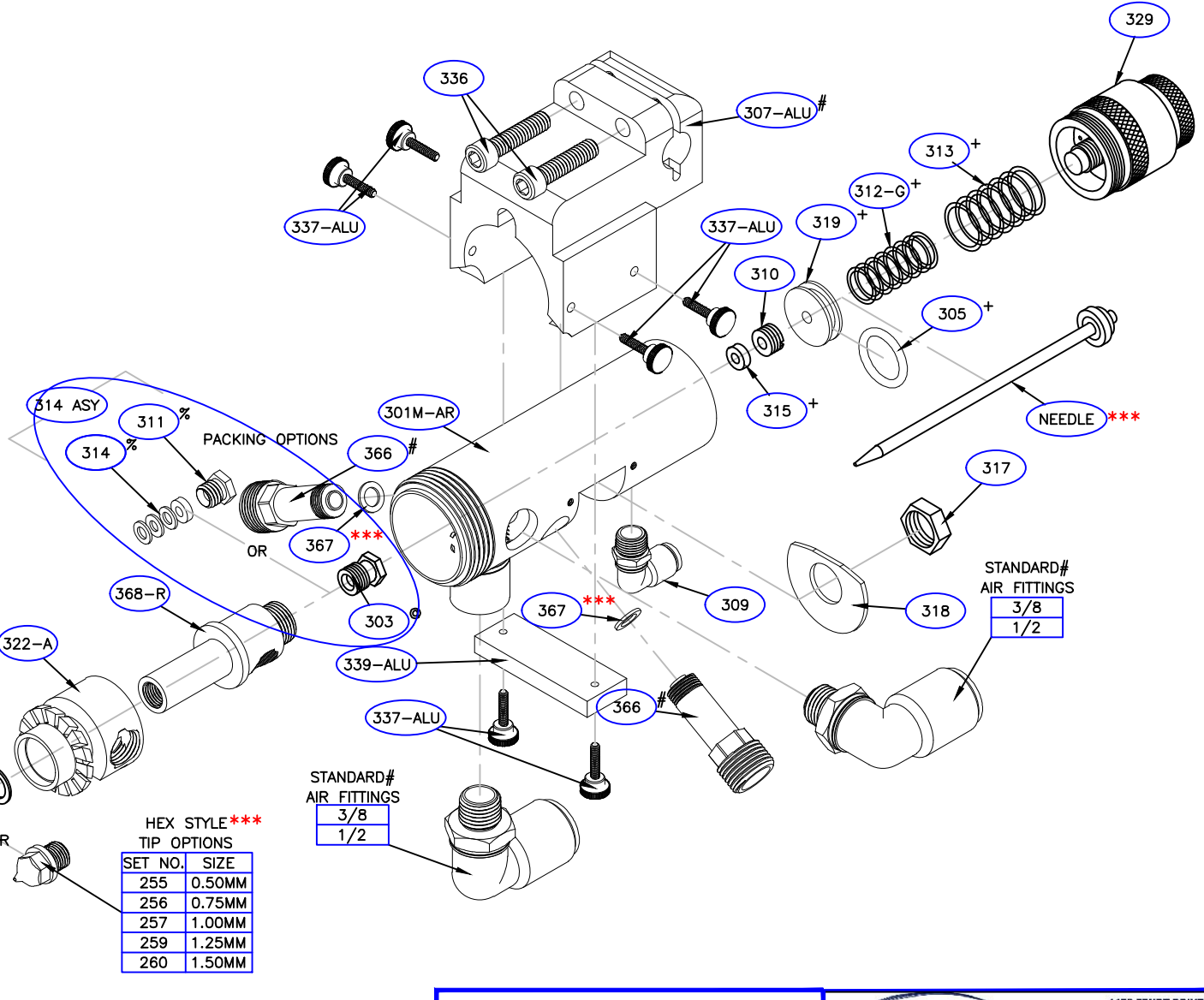

STANDARD***
AIR CAPS#

215
216
218
230
320

WINGED STYLE***
TIP OPTIONS

SET NO.	SIZE
120	1.00MM
121	1.25MM
122	1.50MM
129	1.75MM
131	2.00MM
139	2.50MM

HEX STYLE***
TIP OPTIONS

SET NO.	SIZE
255	0.50MM
256	0.75MM
257	1.00MM
259	1.25MM
260	1.50MM

STANDARD#
AIR FITTINGS

3/8
1/2

STANDARD#
AIR FITTINGS

3/8
1/2

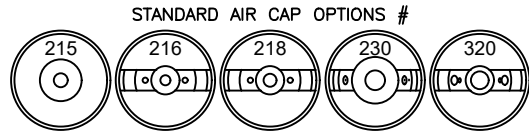

*** = RECOMMENDED SPARE PARTS TO PREVENT DOWN TIME
 # = CONTACT FOR ADDITIONAL OPTIONS AVAILABLE

MODEL #:
300M-AR-ALU

ORDERS/PRICING:
 (517) 548-9096
 ORDERS@TURBOSPRAY.COM

1172 FENDT DRIVE
 HOWELL, MI 48843
 PHONE (517) 548-9096
 FAX (517) 548-9328

**TURBO
 SPRAY**

LEADERS IN LOW PRESSURE SINCE 1980!